

ADDENDUM NO. 001

PROJECT INFORMATION: Porterville College Asphalt Repairs Parking Lot A & B
(North Parking Lot)

Kern Community College District
2100 Chester Ave, Bakersfield, CA 93301

Addendum Dated:
4/2/26

NOTICE TO PROPOSERS OR THEIR AGENTS FIGURING THIS WORK

You are hereby notified of the following changes to the Plans and Specifications.

Item No. 1:

1. The attached drawings revise the scope of work for asphalt seal coating. The two north parking lots will not be resealed, as originally discussed during the job walk. Additionally, the west section of the fire lane, up to the gate, will not be resealed as shown on the original plans.
2. The small storage laydown area will be resealed at a later date (late summer) after all items have been removed.
3. Parking stalls shall be striped in accordance with the attached drawings. All other pavement markings shall be installed to match existing conditions, as discussed during the job walk.

TIME AND PLACE OF BID:

Bids are due on 4/9/26 [date] at 3:00pm- 2100 Chester Ave, Bakersfield, CA 93301. 2nd Floor Facilities office.

END OF ADDENDUM NO. 1

Omar Flores

Name
Kern Community College District
2100 Chester Ave, Bakersfield, CA
93301

Proposer's Acknowledgment

REVISED ASPHALT
SEAL AND STRIP PLAN
3/31/26

Asphalt area to be completed after
furniture is removed at the end of
summer.





FOR DELIVERY ONLY

STAFF ONLY
AT EACH STALL

NO PARKING



ADA
STALLS
REMAIN
THE SAME

NO PARKING
W/ HASH LINES

INSTALL (4)
48"
CONCRETE
BUMPER

STAFF ONLY
AT EACH STALL

STAFF ONLY
AT EACH STALL

STAFF ONLY
AT EACH STALL

C:\Users\lara.chong\Documents\11388-ALLIED-ALLIED_lara.chong.rvt

PLOT DATE: 4/2/2021 10:14:14 AM

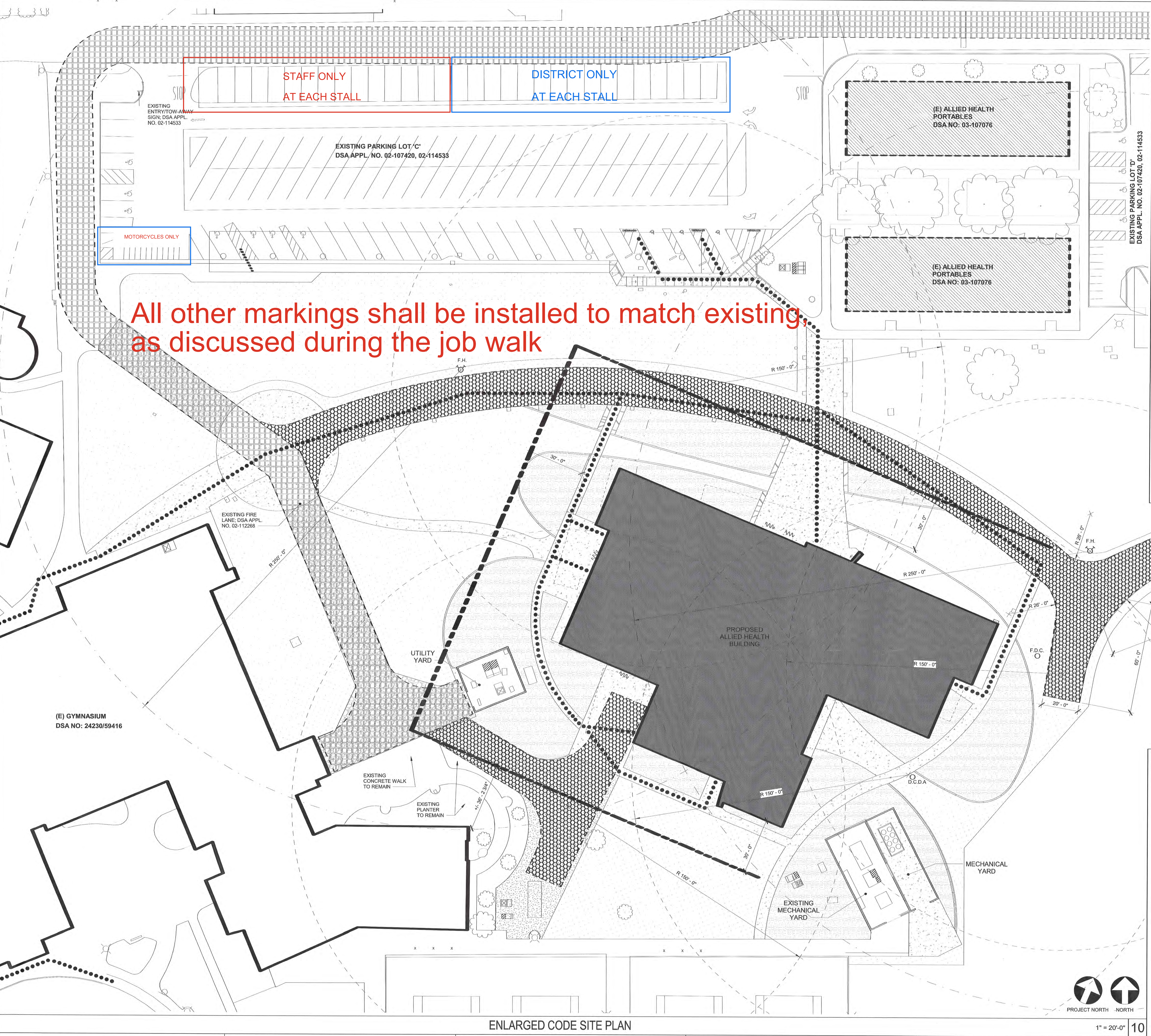

All other markings shall be installed to match existing, as discussed during the job walk

LEGEND

	CONCRETE, SEE CIVIL AND 25 / A111		CLASS II BASE
	TURF, SEE LANDSCAPE		PLANTER, SEE LANDSCAPE
	LIGHT POLE, SEE ELECTRICAL		FIRE HYDRANT, SEE CIVIL
	DOUBLE CHECK DETECTOR ASSEMBLY		FIRE DEPARTMENT CONNECTION, SEE CIVIL
	ASSUMED BUILDING PROPERTY LINE		(E) PROPERTY LINE
	EXISTING 20' WIDE FIRE LANE		PROPOSED 20' WIDE FIRE LANE
	EXISTING BUILDING NOT INCLUDED IN SCOPE OF WORK		NEW BUILDING INCLUDED IN THIS APPLICATION
	EXISTING BUILDING TO BE DEMOLISHED, CAP EXISTING UTILITIES BELOW GRADE AT NEAREST UTILITY BOX		ACCESSIBLE ROUTE (2019 C.B.C. SECTION 11B - 206)

THE ACCESSIBLE ROUTE IS A CONTINUOUS UNOBSTRUCTED PATH CONNECTING ACCESSIBLE ELEMENTS AND SPACES OF AN ACCESSIBLE SITE, BUILDING OR FACILITY THAT CAN BE NEGOTIATED BY A PERSON WITH A DISABILITY USING A WHEELCHAIR, AND THAT IS ALSO SAFE FOR AND USABLE BY PERSONS WITH OTHER DISABILITIES. ACCESSIBLE ROUTES SHALL COMPLY WITH CBC 11B-402. IN GENERAL, EXTERIOR ACCESSIBLE ROUTES SHALL COMPLY WITH THE FOLLOWING: SHALL BE STABLE, FIRM, AND SLIP RESISTANT; HAVE A 1:20 MAXIMUM RUNNING SLOPE FOR WALKS; HAVE A 1:12 MAXIMUM SLOPE FOR RAMPS AND CURB RAMPS; HAVE A 1/4:12 MAXIMUM CROSS SLOPE; HAVE A 48" MINIMUM WIDTH; HAVE NO VERTICAL OFFSETS GREATER THAN 1/4"; OFFSETS BETWEEN 1/4" AND 1/2" SHALL BE BEVELED WITH A SLOPE NOT EXCEEDING 1:20; HAVE NO OPENINGS ALLOWING THE PASSAGE OF A 1/2" DIAMETER SPHERE; ELONGATED OPENINGS SHALL BE PERPENDICULAR TO THE DIRECTION OF TRAVEL; HAVE A MINIMUM 6" HIGH CURB OR GUARDRAIL AT EDGES WHERE THE DROP OFF EXCEEDS 4" EXCEPT WHERE ADJACENT TO VEHICULAR WAYS; BE FREE OF ELEMENTS PROJECTING MORE THAN 4" FROM WALLS BETWEEN 27" AND 80" ABOVE THE WALKING SURFACE; AND HAVE 80" MINIMUM VERTICAL CLEARANCE.

DESIGN PROFESSIONAL IN CHARGE STATEMENT

THE P.O.T. IDENTIFIED IN THESE CONSTRUCTION DOCUMENTS MEETS THE REQUIREMENTS OF THE CURRENT APPLICABLE CALIFORNIA BUILDING CODE (CBC) ACCESSIBILITY PROVISIONS FOR PATH OF TRAVEL REQUIREMENTS FOR ALTERATIONS, ADDITIONS AND STRUCTURAL REPAIRS.

AS PART OF THE DESIGN OF THIS PROJECT, THE P.O.T. WAS EXAMINED AND ANY ELEMENTS, COMPONENTS, OR PORTIONS OF THE P.O.T. THAT WERE DETERMINED TO BE NONCOMPLIANT WITH THE CBC HAVE BEEN IDENTIFIED AND THE CORRECTIVE WORK NECESSARY TO BRING THEM INTO COMPLIANCE HAS BEEN INCLUDED WITHIN THE SCOPE OF THIS PROJECT'S WORK THROUGH DETAILS, DRAWINGS, AND SPECIFICATIONS INCORPORATED INTO THESE CONSTRUCTION DOCUMENTS.

ANY NONCOMPLIANT ELEMENTS, COMPONENTS OR PORTIONS OF THE P.O.T. THAT WILL NOT BE CORRECTED BY THIS PROJECT BASED ON VALUATION THRESHOLD LIMITATIONS OR A FINDING OF UNREASONABLE HARDSHIP ARE INDICATED IN THESE CONSTRUCTION DOCUMENTS.

DURING CONSTRUCTION, IF P.O.T. ITEMS WITHIN THE SCOPE OF THE PROJECT REPRESENTED AS CBC COMPLIANT ARE FOUND TO BE NONCOMPLYING BEYOND REASONABLE CONSTRUCTION TOLERANCES, THEY SHALL BE BROUGHT INTO COMPLIANCE WITH THE CBC AS A PART OF THIS PROJECT BY MEANS OF A CONSTRUCTION CHANGE DOCUMENT.

- ### GENERAL NOTES
- THE CONTRACTOR SHALL ACCEPT THE SITE IN ITS PRESENT CONDITION & DEMOLISH AND/OR REMOVE FROM THE AREA OF THE PROJECT ALL STRUCTURES, BOTH SURFACE & SUBSURFACE, TREES, BRUSH, ROOTS, DEBRIS, ORGANIC MATTER, & ALL OTHER MATTER DETERMINED BY THE INSPECTOR TO BE DELETERIOUS. SUCH MATERIAL SHALL BE REMOVED FROM THE SITE BY THE CONTRACTOR.
 - EXCAVATIONS SHALL BE ADEQUATELY SHORED, BRACED & SHEETED SO THAT THE EARTH WILL NOT SLIDE OR SETTLE & SO THAT ALL EXISTING IMPROVEMENTS OF ANY KIND WILL BE FULLY PROTECTED FROM DAMAGE. WHERE THE EXCAVATION FOR A CONDUIT TRENCH AND/OR STRUCTURE IS FIVE FEET OR MORE IN DEPTH, THE CONTRACTOR SHALL PROVIDE ADEQUATE SHEETING, WHICH SHALL CONFORM TO THE APPLICABLE CONSTRUCTION ORDERS OF THE DIVISION OF INDUSTRIAL SAFETY OF THE STATE OF CALIFORNIA. THE CONTRACTOR SHALL ALWAYS COMPLY WITH OSHA REQUIREMENTS.
 - FINISH GRADE SHALL HAVE A 1.5% SLOPE AWAY FROM THE BLDG. FOR A DISTANCE NOT LESS THAN 5'-0" FROM THE BLDG.
 - EXISTING UNDERGROUND UTILITIES & IMPROVEMENTS ARE SHOWN IN THEIR APPROX. LOCATIONS BASED UPON RECORD INFO. AVAILABLE TO THE ARCHITECT AT THE TIME OF PREPARATION OF THESE PLANS. LOCATIONS MAY NOT HAVE BEEN VERIFIED IN THE FIELD & NO GUARANTEE IS MADE AS TO THE ACCURACY OR COMPLETENESS OF THE INFO. SHOWN. THE CONTRACTOR SHALL NOTIFY UTILITY COMPANIES AT LEAST 2 WORKING DAYS IN ADVANCE OF CONSTRUCTION TO FIELD LOCATE UTILITIES. CALL UNDERGROUND SERVICE ALERT (U.S.A.), 1-800-642-2444.
 - ALL SITE CONC. CURBS, GUTTERS, DRIVE APPROACHES, & WALKS SHALL BE CLASS II CONC. (6 SACK MIX) WITH A MAX. SLUMP OF 5" & A 28 DAY COMPRESSIVE STRENGTH OF 2000 PSI.
 - EXTERIOR CONC. LANDINGS AT DOORS SHALL NOT BE MORE THAN 1/2 INCH LOWER THAN DOORWAY THRESHOLD WITH 1/4 INCH PER FOOT SLOPE MAX.
 - REFER TO CIVIL, LANDSCAPE, PLUMBING & ELECTRICAL FOR UTILITY INFORMATION. CONTRACTOR TO COORDINATE ALL TRADES TO MAINTAIN PROPER CLEARANCES & AVOID CONFLICTS.
 - DISTRICT/ COLLEGE SHALL HAVE FIRST RIGHT OF SALVAGE.

IDENTIFICATION STAMP
DIV. OF THE STATE ARCHITECT
APP: 02-118445 INC.
REVIEWED FOR
SS FLS ACS
DATE: 04/29/2021

MARK	DATE	DESCRIPTION
D	4/1/21	DSA BACK-CHECK

TETER, LLP
FRESNO HEADQUARTERS
VANDIA | BAKERSFIELD | MODESTO | SAN LUIS OBISPO
ARCHITECTS ENGINEERS CONNECTED

TETER

ALLIED HEALTH BUILDING
PORTERVILLE COLLEGE
100 E. COLLEGE AVE.
PORTERVILLE, CA

DRAWING TITLE
ENLARGED CODE SITE PLAN

PROJECT NO.
19-11388

DRAWING
G101