



## ADDENDUM

**BC SMSR 2022-2023 Wall and Floorcovering  
Replacement Library Phase II  
Bakersfield College  
KCCD  
550-0059**

**Date: April 1, 2026**

**To: All Bidders**

**Subject: Addendum #1**

**Total Addendum includes:  
[2] 8.5x11**

### NOTICE TO CONTRACTORS FIGURING THIS WORK

You are hereby notified of the following changes in the Plans and Specifications, which shall take precedence over anything to the contrary therein.

#### **Item # Description**

#### **1.1 Refer to Sheet A2.10 FLOOR PLAN:**

- 1.1.1 Refer to Room 127 COMMONS. All existing computer equipment and computer desks in this room to remain in place during construction. Contractor to lift all furniture/equipment in place as required to perform flooring work. Computers are hardwired to the network and cannot be disconnected or moved from their locations. Computers/equipment/cords/desks to be protected during duration of work. Contractor to field verify quantity of computer equipment and furniture prior to bid.
- 1.1.2 Refer to Keynote 13. Clarification: Existing wall guards and corner guards are CS Products/Acrovyn snap-on rigid bumper rail wall guards and corner guards. Contractor to verify height/width/length of existing guards and confirm compatibility of new covers with existing backing. Provide full range of standard colors for Architect's selection.

#### **1.2 Refer to Sheet A5.10 REFLECTED CEILING PLAN:**

- 1.2.1 Refer to Keynote 11. Clarification: Contractor to allow for 50% total ceiling area tile replacement. Any unused tiles of that allotment shall be installed on the Second Floor of the Library building, in locations directed in field by the Owner/Architect.

#### **1.3 Refer to attached Building Access Diagram:**

- 1.3.1 Sketch provides information regarding Contractor building entrance access for the duration of project work.

#### **1.4 Library Building Schedule for Contractor Access:**

- 1.4.1 Contractor will have access to the project area (first floor) starting May 16. Access to the second floor will be limited and will require prior scheduling with Owner.

End of addendum

**BC**  
**SMSR 2022-2023**  
**WALL AND**  
**FLOORCOVERING**  
**REPLACEMENT**  
**LIBRARY PHASE 2**

Bakersfield College  
1801 Panorama Dr. Bakersfield, CA 93305  
Kern Community College District

ARCHITECT

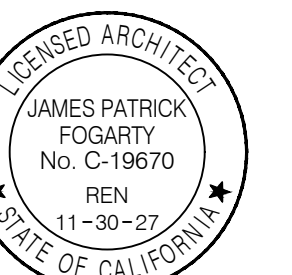

JAMES PATRICK FOGARTY, AIA  
ARCHITECT C-19670

CONSULTANT

DSA

**PROJECT INFO**

Project No: 550-0559  
Date: 03.05.2025

**REVISIONS**

No	Date	Item
1	00.00.26	DESCRIPTION

THESE DRAWINGS ARE INSTRUMENTS OF SERVICE AND ARE THE PROPERTY OF AP ARCHITECTS. ALL DESIGNS AND DRAWINGS ARE FOR THE USE ON THE SPECIFIED PROJECT AND SHALL NOT BE USED OTHERWISE WITHOUT THE EXPRESSED WRITTEN PERMISSION OF AP ARCHITECTS. WRITTEN SHALL HAVE PRECEDENCE OVER SCALED DIMENSIONS. CONTRACTORS SHALL VERIFY AND BE RESPONSIBLE FOR ALL DIMENSIONS AND CONDITIONS SHOWN BY THESE DRAWINGS. SHOP DETAILS SHALL BE SUBMITTED TO THIS OFFICE FOR APPROVAL BEFORE PROCEEDING WITH FABRICATION. © COPYRIGHT 03.16.26.14.44

FLOOR PLAN

**A2.10**

**GENERAL NOTES**

- PROTECT ALL EXISTING FIRE ALARM DEVICES, FIRE EXTINGUISHER CABINETS, LIGHTING, ETC NOT INDICATED TO BE PAINTED.
- ALLOW FOR REMOVAL AND REINSTALLATION OF ALL WALL MOUNTED SWITCHES, INFORMATIONAL SIGNS, ETC AT WALLS TO BE PAINTED OR RECOATED. CONFIRM WITH OWNER PRIOR TO REMOVAL.
- ALL EXISTING LIGHTING TO REMAIN - PROTECT FIXTURES.
- ALL WALL GUARD AND CORNER GUARD MOUNTING BACKING TO REMAIN WHERE WALL GUARD/CORNER GUARD COVERS ARE COLORED GREEN COVERS ARE TO BE REMOVED AND REPLACED WITH NEW COVERS. WHERE WALL GUARD/CORNER GUARD COVERS ARE COLORED GREY, WHITE, TAN COVERS ARE TO BE REMOVED AND REINSTALLED.
- REMOVE ALL EXISTING RWB AND REPLACE ALL WITH 4" RWB.
- PAINT ALL HM FRAMES AT DOORS AND WINDOWS WITHIN PROJECT SCOPE LIMITS. JAMBS AND FACES OF FRAMES WITH PORTIONS WITHIN PROJECT SCOPE LIMITS AND PORTIONS NOT WITHIN PROJECT SCOPE LIMITS SHALL RECEIVE PAINT ON ALL FACES.
- EXISTING BUILDING DEVICES, FIRE ALARM ACCESSORIES, FIRE EXTINGUISHER CABINETS, ETC TO REMAIN IN PLACE. CAREFULLY PAINT AROUND DEVICES.

**KEYNOTES**

- NOT USED
- EXISTING WALL WITH WALLCOVERING MATERIAL TO BE PAINTED. REMOVE WALLCOVERING AND ADHESIVE. TEXTURE/PREP WALL TO MATCH ADJACENT EXISTING TEXTURE TO RECEIVE PAINT.
- EXISTING WALL WITH VINYL TACKBOARD SURFACE TO REMAIN. PAINT OVER EXISTING TACKBOARD SURFACE - ALTERNATE 02.
- EXISTING ELECTRICAL FLOOR BOX. INSTALL NEW CARPET IN COVER - CONTRACTOR TO VERIFY QUANTITY IN FIELD.
- REMOVE RUBBER WALL BASE. INSTALL NEW 4-1/2" TALL RUBBER WALL BASE.
- REMOVE EXISTING CARPET, SUBFLOOR AND RUBBER WALL BASE. INSTALL NEW CARPET AND 4-1/2" TALL RUBBER WALL BASE. SEE FLOORING LEGEND FOR CARPET INFORMATION.
- REMOVE EXISTING WALL MOUNTED MIRROR.
- REMOVE EXISTING WALL MOUNTED CAMERA/DEVICE/SURFACE MOUNTED WIRING.
- EXISTING ALUMINUM STOREFRONT SYSTEM TO REMAIN. PROTECT.
- REMOVE EXISTING RUBBER FLOOR. INSTALL NEW LVT FLOC - ALTERNATE 01.
- REMOVE AND REPLACE 2X2 CEILING TILE. SEE SPECS FOR MORE INFORMATION - EXISTING GRID TO REMAIN. ALLOW FOR 50% OF TOTAL EXISTING CEILING TILE AREA REPLACEMENT. EXACT LOCATION OF REPLACED TILES TO BE COORDINATED IN FIELD WITH OWNER/ARCHITECT. ANY CEILING ACCESSORY, VENT, ETC LOCATED AT A REPLACED CEILING TILE SHALL BE REMOVED AND REINSTALLED.
- EXISTING WALL GUARD/CORNER GUARD TO REMAIN. REMOVE AND REINSTALL COVER TO PERFORM WORK - BACKING ANCHORS/RAILS TO REMAIN INSTALLED. SEE ALSO GENERAL NOTE 4.
- EXISTING WALL GUARD/CORNER GUARD TO REMAIN. REMOVE AND REPLACE COVER PLATE WITH NEW COVER PLATE - BACKING ANCHORS/RAILS TO REMAIN INSTALLED. SEE ALSO GENERAL NOTE 4.
- REMOVE AND REINSTALL EXISTING STONE THRESHOLD AS REQUIRED TO PERFORM FLOORING WORK.
- REMOVE AND REINSTALL METAL THRESHOLD AS REQUIRED TO PERFORM FLOORING WORK.
- EXISTING HIGH WALL/SOFFIT WITH WALLCOVERING MATERIAL TO BE PAINTED. REMOVE WALLCOVERING AND ADHESIVE. TEXTURE/PREP WALL TO MATCH ADJACENT EXISTING TEXTURE TO RECEIVE PAINT. PAINT UNDERSIDE AND VERTICAL FACES.
- REMOVE PLASTIC LAMINATE FINISH AT ALL FACES OF COUNTERTOP. INSTALL NEW PLASTIC LAMINATE FINISH AT ALL FACES OF COUNTERTOP.

**CEILING TYPE LEGEND**

Type	Description
TYPE B	EXISTING GYPSUM BOARD - PATCH/PAINT
TYPE F	EXISTING 2X2X2 CEILING GRID WITH LAY-IN ACOUSTIC PANELS. GRID TO REMAIN. LAY-IN ACOUSTIC PANELS TO BE REMOVED AND REPLACED - SEE SPECIFICATIONS.

**PAINT LEGEND**

Color	Description
P1	DUNN EDWARDS - DE 6225 FOSSIL EGGSHELL FINISH
P2	DUNN EDWARDS - DET 629 RECLAIMED WOOD EGGSHELL FINISH
P3	COLOR MATCH TO DRYWIT KING'S GRAY EGGSHELL FINISH
P4	DUNN EDWARDS - DET 429 PASADENA ROSE EGGSHELL FINISH

**FLOORING LEGEND**

Tag	Description	Hatch
F1	MANNINGTON CARPET TILE - 12"X36" ECHOING THREADS COLLECTION SENSORY WAVE PORPHOSE 84704 - VERTICAL ASH/LAR PATTERN	
F2	LVT - PROVIDED BY OWNER INSTALLED BY CONTRACTOR	

**REDUCER STRIP SCHEDULE**

No	Type	Mfr
RA1	REDUCER STRIP - EXISTING CARPET TO CARPET	MANNINGTON
RA2	REDUCER STRIP - LVT TO CARPET	MANNINGTON
RA3	REDUCER STRIP - CARPET TO EXISTING FLOORING (CONFIRM IN FIELD - IF METAL THRESHOLD REMOVE AND REINSTALL)	MANNINGTON

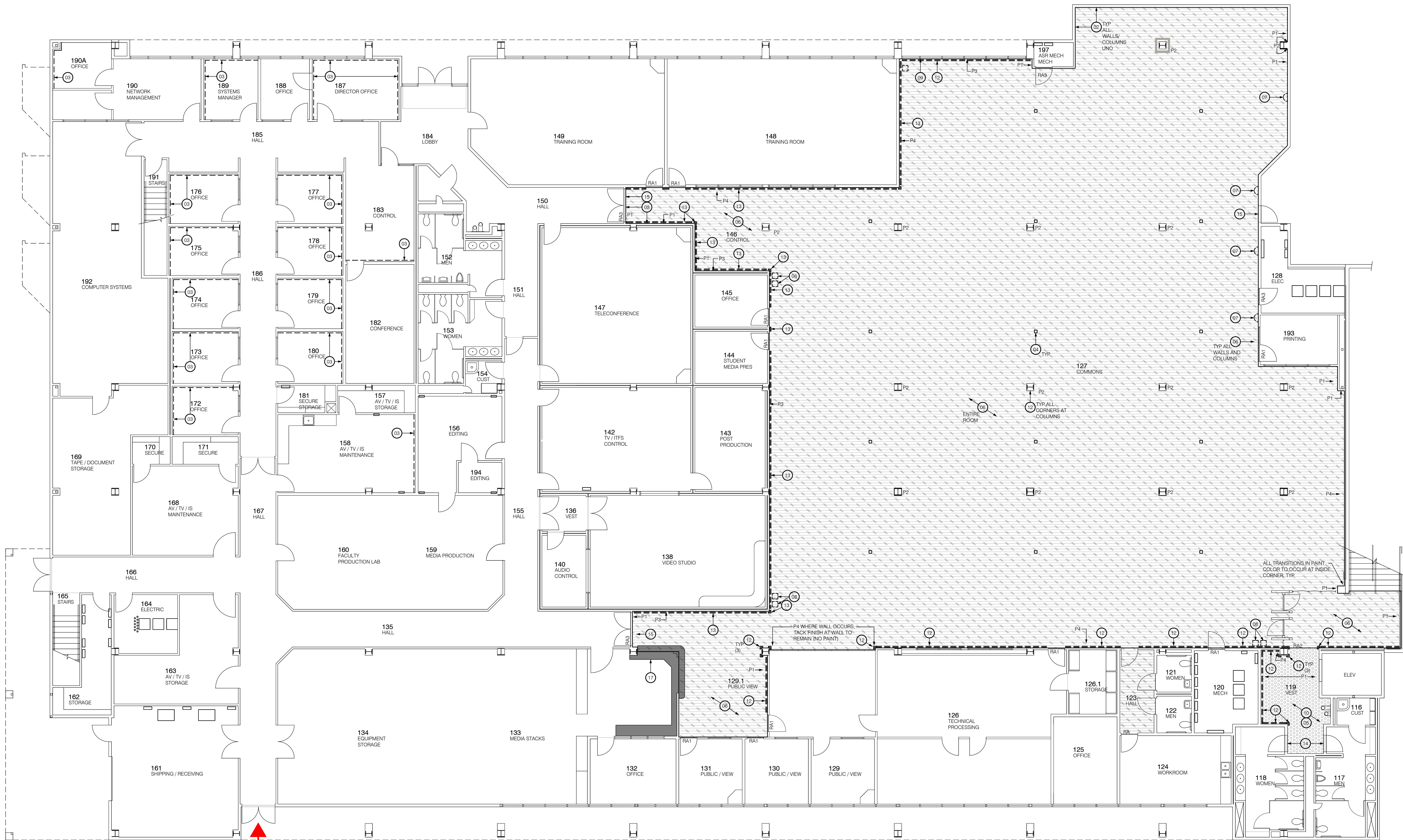

**CONTRACTOR ACCESS TO FIRST FLOOR - CENTRAL DOOR ASTRAGAL IS REMOVEABLE**

**BUILDING ACCESS DIAGRAM**

Floor Plan - Entrance  
Scale: 1/8" = 1'-0"

